



MINISTER FOR THE ENVIRONMENT; SCIENCE

000714

STATEMENT THAT A PROPOSAL MAY BE IMPLEMENTED  
(PURSUANT TO THE PROVISIONS OF THE  
ENVIRONMENTAL PROTECTION ACT 1986)

ABERNETHY ROAD – TONKIN HIGHWAY ON-RAMP  
KEWDALE, CITY OF BELMONT

**Proposal:** Construction of an on-ramp from Abernethy Road to Tonkin Highway in Kewdale, City of Belmont, as documented in schedule 1 of this statement.

**Proponent:** Main Roads Western Australia

**Proponent Address:** Don Aitkens Centre  
Waterloo Crescent  
EAST PERTH WA 6004

**Assessment Number:** 1439

**Report of the Environmental Protection Authority:** Bulletin 1119

The proposal referred to above may be implemented by the proponent subject to the following conditions and procedures:

**1 Implementation**

1-1 The proponent shall implement the proposal as documented in schedule 1 of this statement subject to the conditions and procedures of this statement.

**2 Proponent Commitments**

2-1 The proponent shall implement the environmental management commitments documented in schedule 2 of this statement.

Published on

25 JAN 2006

### **3 Proponent Nomination and Contact Details**

- 3-1 The proponent for the time being nominated by the Minister for the Environment under section 38(6) or (7) of the *Environmental Protection Act 1986* is responsible for the implementation of the proposal until such time as the Minister for the Environment has exercised the Minister's power under section 38(7) of the Act to revoke the nomination of that proponent and nominate another person as the proponent for the proposal.
- 3-2 If the proponent wishes to relinquish the nomination, the proponent shall apply for the transfer of proponent and provide a letter with a copy of this statement endorsed by the proposed replacement proponent that the proposal will be carried out in accordance with this statement. Contact details and appropriate documentation on the capability of the proposed replacement proponent to carry out the proposal shall also be provided.
- 3-3 The nominated proponent shall notify the Department of Environment of any change of contact name and address within 60 days of such change.

### **4 Commencement and Time Limit of Approval**

- 4-1 The proponent shall substantially commence the proposal within five years of the date of this statement or the approval granted in this statement shall lapse and be void.

Note: The Minister for the Environment will determine any dispute as to whether the proposal has been substantially commenced.

- 4-2 The proponent shall make application for any extension of approval for the substantial commencement of the proposal beyond five years from the date of this statement to the Minister for the Environment, prior to the expiration of the five-year period referred to in condition 4-1.

The application shall demonstrate that:

1. the environmental factors of the proposal have not changed significantly;
2. new, significant, environmental issues have not arisen; and
3. all relevant government authorities have been consulted.

Note: The Minister for the Environment may consider the grant of an extension of the time limit of approval not exceeding five years for the substantial commencement of the proposal.

### **5 Compliance Auditing and Performance Review**

- 5-1 The proponent shall prepare an audit programme and submit compliance reports to the Department of Environment which address:

1. the status of implementation of the proposal as defined in schedule 1 of this statement;
2. evidence of compliance with the conditions and commitments; and
3. the performance of the environmental management plans and programs.

Note: Under sections 48(1) and 47(2) of the *Environmental Protection Act 1986*, the Chief Executive Officer of the Department of Environment is empowered to monitor the compliance of the proponent with the statement and should directly receive the compliance documentation, including environmental management plans, related to the conditions, procedures and commitments contained in this statement.

## **6 Mitigation Strategy**

- 6-1 Prior to commencement of construction, the proponent shall develop a Mitigation Strategy to the requirements of the Minister for the Environment on advice of the Environmental Protection Authority, the Department of Conservation and Land Management and the Department for Planning and Infrastructure (Bush Forever Office).

The Mitigation Strategy shall provide for:

1. the acquisition of land, preferably within the local area, which assists in the protection and conservation of an area of significant environmental value and which is comparable to the area to be impacted by the construction of the on-ramp; and
  2. the contribution to the improved management, protection and conservation of nearby areas of environmental significance which are comparable to the area to be impacted by the construction of the on-ramp. The contribution should assist in the following types of management, protection and conservation measures:
    - fencing;
    - weed control;
    - rehabilitation of degraded areas; and
    - signage.
- 6-2 The proponent shall implement the Mitigation Strategy required by condition 6-1.
- 6-3 The proponent shall make the Mitigation Strategy required by condition 6-1 publicly available.

## **7 Construction Environmental Management Plan**

- 7-1 Prior to commencement of ground-disturbing activity, the proponent shall prepare a Construction Environmental Management Plan to the requirements of the Minister for the Environment on advice of the Environmental Protection Authority, the Department

of Conservation and Land Management and the Department of Consumer and Employment Protection.

The objectives of this Plan are:

- To minimise the impacts of construction works on the adjacent vegetation and fauna habitat within Bush Forever Site 386.

This Plan shall address/include:

1. vegetation and clearing controls to limit clearing to 0.85 hectares;
2. significant tree identification;
3. dieback and weed hygiene;
4. topsoil and landscaping plan;
5. fencing of construction area;
6. drainage management;
7. environmental inductions;
8. a hydrocarbon Spill Containment Plan prepared in liaison with the Department of Consumer and Employment Protection;
9. fire risk management; and
10. environmental auditing.

7-2 The proponent shall implement the Construction Environmental Management Plan required by condition 7-1.

7-3 The proponent shall make the Construction Environmental Management Plan required by condition 7-1 publicly available.

### **Procedures**

1. Where a condition states "to the requirements of the Minister for the Environment on advice of the Environmental Protection Authority", the Environmental Protection Authority will provide that advice to the Department of Environment for the preparation of written notice to the proponent.
  2. The Environmental Protection Authority may seek advice from other agencies or organisations, as required, in order to provide its advice to the Department of Environment.
  3. Where a condition lists advisory bodies, it is expected that the proponent will obtain the advice of those listed as part of its compliance reporting to the Department of Environment.
-

## Notes

1. The Minister for the Environment will determine any dispute between the proponent and the Environmental Protection Authority or the Department of Environment over the fulfilment of the requirements of the conditions.
2. Within this statement, to “have in place” means to “prepare, document, implement and maintain for the duration of the proposal”.

Dr Judy Edwards MLA  
MINISTER FOR THE ENVIRONMENT; SCIENCE

25 JAN 2006

## Schedule 1

### The Proposal (Assessment No. 1439)

The proposal involves the construction of an on-ramp from Abernethy Road to Tonkin Highway, Kewdale, in the City of Belmont (see Figure 1 attached).

Construction of all road pavements, a stormwater detention basin and associated works are also included.

The key characteristics of the proposal are shown in Table 1 below.

**Table 1 - Key Proposal Characteristics**

<b>Element</b>	<b>Description</b>
Construction duration	4 months (approximately)
Operation life of proposal	Ongoing (30 years plus)
Area of disturbance (maximum)	0.85 hectares
Components	<ul style="list-style-type: none"><li>• Single traffic lane on-ramp to Tonkin Highway;</li><li>• Cycle path on inside of on-ramp; and</li><li>• Drainage treatments and detention basin.</li></ul>
Traffic volume	Approximately 5,700 vehicle movements per day by 2021.
Environmental mitigation	Acquisition of bushland area of at least an equivalent area of comparable ecological value to that which is impacted by the construction of the on-ramp, and a contribution to the management, protection and conservation of nearby areas of comparable conservation significance.

**Figure (attached)**

Figure 1 - Proposed Abernethy Road – Tonkin Highway On-ramp.

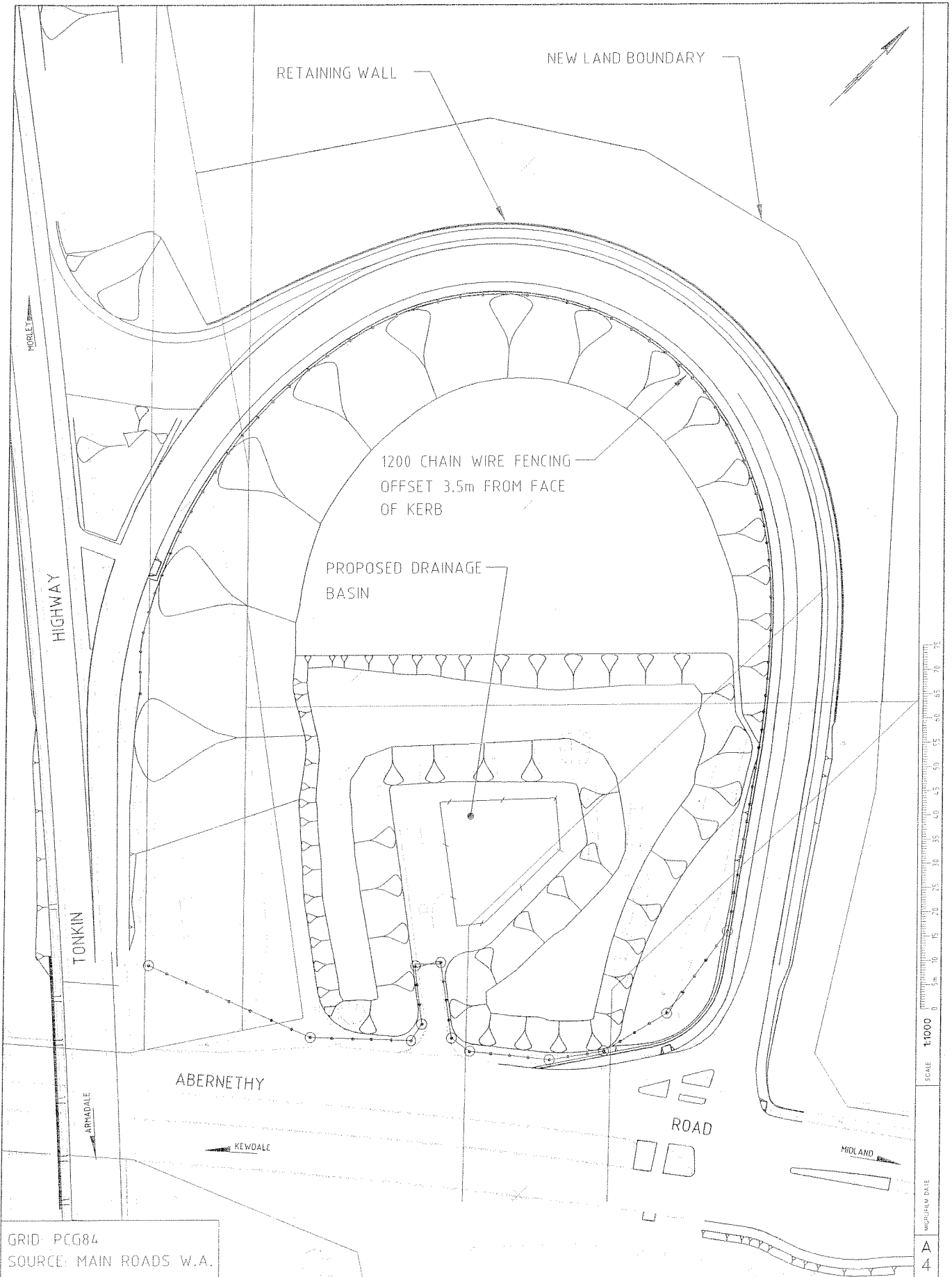

GRID: PCG84  
SOURCE: MAIN ROADS W.A.

 Government of  
**Western Australia**  

**MAIN ROADS**  
 Western Australia  
 TECHNOLOGY AND ENVIRONMENT DIRECTORATE  
 ROAD AND TRAFFIC ENGINEERING  
 WATERLOO CRESCENT EAST PERTH 6004  
 Telephone (08) 9323 4111 Fax (08) 9323 4449

**FIGURE 1**  
 PROPOSED ABERNETHY ROAD - TONKIN HIGHWAY  
 ON-RAMP  
 LOCAL AUTHORITY

DESIGNED	VERIFIED
DRAWN J. COOK	APPROVED
FILE NUMBER	
DRAWING NUMBER 200531-0044	AMENDMENT

Proponent's Environmental Management Commitments

August 2005

**ABERNETHY ROAD – TONKIN HIGHWAY  
ON-RAMP  
KEWDALE, CITY OF BELMONT**

(Assessment No. 1439)

Main Roads Western Australia

---



Proponent's Environmental Management Commitments

ABERNETHY ROAD – TONKIN HIGHWAY ON-RAMP, KEWDALE, CITY OF BELMONT – August 2005 (Assessment No. 1439)

Note: The term "commitment" as used in this schedule includes the entire row of the table and its six separate parts as follows:

- a commitment number;
- a commitment topic;
- the objective of the commitment;
- the 'action' to be undertaken by the proponent;
- the timing requirements of the commitment; and
- the body/agency to provide technical advice to the Department of Environment.

No.	Topic	Objective	Action	Timing	Advice
1	Drainage Management	<p>To ensure continued function.</p> <p>To ensure that no road surface run-off directly enters the wetland.</p> <p>To ensure that there is provision for contaminant spillage entrapment.</p> <p>To ensure continued function in disposal of road run-off and infiltration/recharge to the local aquifer.</p>	Monitor the infiltration basin	Post-construction / ongoing	CALM

No.	Topic	Objective	Action	Timing	Advice
2	Drainage Management	<p>To ensure continued function.</p> <p>To ensure that no road surface run-off directly enters the wetland.</p> <p>To ensure that there is provision for contaminant spillage entrapment.</p> <p>To ensure continued function in disposal of road run-off and infiltration/recharge to the local aquifer.</p>	<p>Maintain the infiltration basin as required.</p>	Ongoing	
3	Drainage Management	<p>To ensure continued function.</p> <p>To ensure that no road surface run-off directly enters the wetland.</p> <p>To ensure that there is provision for contaminant spillage entrapment.</p> <p>To ensure continued function in disposal of road run-off and infiltration/recharge to the local aquifer.</p>	<p>Prepare a Drainage Management Contingency Plan.</p>	Prior to construction	CALM
4	Drainage Management	<p>To ensure continued function.</p> <p>To ensure that no road surface run-off directly enters the wetland.</p> <p>To ensure that there is provision for contaminant spillage entrapment.</p> <p>To ensure continued function in disposal of road run-off and infiltration/recharge to the local aquifer.</p>	<p>Implement the Drainage Management Contingency Plan referred to in commitment 3.</p>	Prior to construction	

No.	Topic	Objective	Action	Timing	Advice
5	Priority Flora	To ensure that CALM management requirements for threatened flora species are met.	Develop specific management measures for the local individuals of <i>Verticordia lindleyi</i> subsp. <i>lindleyi</i> in liaison with CALM.	Pre-construction.	CALM
6	Priority Flora	To ensure that CALM management requirements for threatened flora species are met.	Implement the specific management measures referred to in commitment 5 above.	During construction	CALM
7	Acid Sulfate Soils	To ensure that adjacent wetland areas are not impacted by any acid drainage which may arise from sediments exposed during construction.	Conduct Acid Sulfate Soils testing in accordance with DoE requirements.	Prior to commencement of earthworks.	
8	Acid Sulfate Soils	To ensure that adjacent wetland areas are not impacted by any acid drainage which may arise from sediments exposed during construction.	Implement Acid Sulfate Soils assessment and management procedures in accordance with DoE requirements.	During construction.	
9	Aboriginal Heritage	To ensure that no sites of significance to Aboriginal people are impacted.	Prepare an Aboriginal Heritage Management Plan, to specify archaeological monitoring to be carried out during construction activities.	Prior to commencement of construction.	DIA
10	Aboriginal Heritage	To ensure that no sites of significance to Aboriginal people are impacted.	Implement the Aboriginal Heritage Management Plan.	During construction.	DIA

**Abbreviations:**

CALM Department of Conservation and Land Management  
DIA Department of Indigenous Affairs  
DoE Department of Environment