



Statement No.

000493

MINISTER FOR THE ENVIRONMENT;
LABOUR RELATIONS

STATEMENT THAT A PROPOSAL MAY BE IMPLEMENTED
(PURSUANT TO THE PROVISIONS OF THE
ENVIRONMENTAL PROTECTION ACT 1986)

WASTEWATER TREATMENT PLANT, STAGE 1 AT CHUGG STREET, WALPOLE
SHIRE OF MANJIMUP

Proposal: The proposal is to construct, commission, operate and maintain a 1,000 equivalent persons capacity wastewater treatment plant to serve the Walpole townsite and its environs, as documented in schedule 1 of this statement. The site is known as Site C, located on Chugg Street, Walpole, on a predominantly cleared portion of "C" Class Crown Reserve No. 29778 (Forestry Purposes), currently used as a depot by the Department of Conservation and Land Management. (See Figures 1 and 2.)

Treatment will be by means of an extended aeration/activated sludge plant. Initial low levels of tertiary treated effluent will be disposed of in a sub-surface infiltration trench located beneath an existing six metre firebreak/access track abutting and partly within the Walpole-Nornalup National Park. A treelot is planned for future disposal of the treated effluent.

Proponent: Water Corporation

Proponent Address: 629 Newcastle Street, Leederville 6007

Assessment Number: 1154

Report of the Environmental Protection Authority: Bulletin 909

The proposal to which the above report of the Environmental Protection Authority relates may be implemented subject to the following conditions and procedures:

1 Implementation

- 1-1 Subject to these conditions and procedures, the proponent shall implement the proposal as documented in schedule 1 of this statement.
- 1-2 Where the proponent seeks to change any aspect of the proposal as documented in schedule 1 of this statement in any way that the Minister for the Environment determines, on advice of the Environmental Protection Authority, is substantial, the proponent shall refer the matter to the Environmental Protection Authority.

Published on

- 2 FEB 1999

- 1-3 Where the proponent seeks to change any aspect of the proposal as documented in schedule 1 of this statement in any way that the Minister for the Environment determines, on advice of the Environmental Protection Authority, is not substantial, those changes may be effected.

2 Proponent Commitments

- 2-1 The proponent shall implement the consolidated environmental management commitments documented in schedule 2 of this statement.
- 2-2 The proponent shall implement subsequent environmental management commitments which the proponent makes as part of the fulfilment of conditions and procedures in this statement.

3 Performance Review

- 3-1 Each six years following the commencement of construction, the proponent shall submit a Performance Review to the Department of Environmental Protection:

- to document the outcomes, beneficial or otherwise;
- to review the success of goals, objectives and targets; and
- to evaluate the environmental performance over the six years;

relevant to the following:

- 1 environmental objectives reported on in Environmental Protection Authority Bulletin 909;
- 2 proponent's consolidated environmental management commitments documented in schedule 2 of this statement and those arising from the fulfilment of conditions and procedures in this statement;
- 3 environmental management system environmental management targets;
- 4 environmental management programs and plans; and/or
- 5 environmental performance indicators;

to the requirements of the Environmental Protection Authority on advice of the Department of Environmental Protection.

Note: The Environmental Protection Authority may recommend changes and actions to the Minister for the Environment following consideration of the Performance Review.

4 Proponent

- 4-1 The proponent for the time being nominated by the Minister for the Environment under section 38(6) or (7) of the Environmental Protection Act 1986 is responsible for the implementation of the proposal until such time as the Minister for the Environment has exercised the Minister's power under section 38(7) of the Act to revoke the nomination of that proponent and nominate another person in respect of the proposal.

- 4-2 Any request for the exercise of that power of the Minister referred to in condition 4-1 shall be accompanied by a copy of this statement endorsed with an undertaking by the proposed replacement proponent to carry out the proposal in accordance with the conditions and procedures set out in the statement.
- 4-3 The proponent shall notify the Department of Environmental Protection of any change of proponent contact name and address within 30 days of such change.

5 Commencement

- 5-1 The proponent shall provide evidence to the Minister for the Environment within five years of the date of this statement that the proposal has been substantially commenced.
- 5-2 Where the proposal has not been substantially commenced within five years of the date of this statement, the approval to implement the proposal as granted in this statement shall lapse and be void. The Minister for the Environment will determine any question as to whether the proposal has been substantially commenced.
- 5-3 The proponent shall make application to the Minister for the Environment for any extension of approval for the substantial commencement of the proposal beyond five years from the date of this statement at least six months prior to the expiration of the five year period referred to in conditions 5-1 and 5-2.
- 5-4 Where the proponent demonstrates to the requirements of the Minister for the Environment on advice of the Environmental Protection Authority that the environmental parameters of the proposal have not changed significantly, then the Minister may grant an extension not exceeding five years for the substantial commencement of the proposal.

6 Compliance Auditing

- 6-1 The proponent shall submit periodic Performance and Compliance Reports, in accordance with an audit program prepared in consultation between the proponent and the Department of Environmental Protection.
- 6-2 Unless otherwise specified, the Chief Executive Officer of the Department of Environmental Protection is responsible for assessing compliance with the conditions, procedures and commitments contained in this statement and for issuing formal clearances.
- 6-3 Where compliance with any condition, procedure or commitment is in dispute, the matter will be determined by the Minister for the Environment.

Note

- 1 The proponent is required to apply for a Works Approval and Licence for this project under the provisions of Part V of the Environmental Protection Act.

CHERYL EDWARDES (MRS) MLA
MINISTER FOR THE ENVIRONMENT

- 2 FEB 1999

Schedule 1

The Proposal

The proposal is to construct, commission, operate and maintain a wastewater treatment plant to serve the Walpole townsite and its environs. The site is known as Site C, located on Chugg Street, Walpole, on a predominantly cleared portion of "C" Class Crown Reserve No. 29778 (Forestry Purposes), currently used as a depot by the Department of Conservation and Land Management. The location of the proposal and site layout are shown in Figures 1 and 2.

The treatment is by means of an extended aeration/activated sludge plant of 1,000 equivalent persons capacity, producing final treated wastewater of less than 1 milligram per litre total phosphorus, less than 10 milligrams per litre total nitrogen, less than 10 milligrams per litre five-day biological oxygen demand, less than 20 milligrams per litre suspended solids and less than 150 thermotolerant coliforms per 100 millilitres.

Initially, while the volume of treated effluent is low, it will be disposed of in a sub-surface infiltration trench located beneath an existing six metre firebreak/access track abutting and partly within the Walpole-Nornalup National Park. (When sufficient volumes are available, the treated effluent will be discharged to a treelot which is not part of this proposal.)

The design and construction of the plant will be performance-based on the above treated wastewater output. Construction is expected to commence early in 1999 and be of about six months' duration.

Key Characteristics Table

Element	Quantities/Description
Life of project	Longterm - until service requirements exceed 1,000 equivalent persons - not known
Output (treated effluent)	200 cubic metres per day at full capacity First year output is estimated to be less than 20 cubic metres per day
Estimated quality of output	Less than: 1 milligram per litre total phosphorus; 10 milligrams per litre total nitrogen; 10 milligrams per litre 5-day biological oxygen demand; 20 milligrams per litre suspended solids; and 150 thermotolerant coliforms per 100 millilitres
Area of disturbance: treatment plant (including access) infiltration trench (beneath existing cleared track)	Less than 1 hectare 208 metres long and 3 metres deep

List of major components - plant laboratory power supply chemical storage sludge drying beds infiltration trench car parking area	See final plans and specifications for details.
--------------------------------------------------------------------------------------------------------------------------------------------------------	-------------------------------------------------

Figures and plans

Figure 1: Site location

Figure 2: Site layout

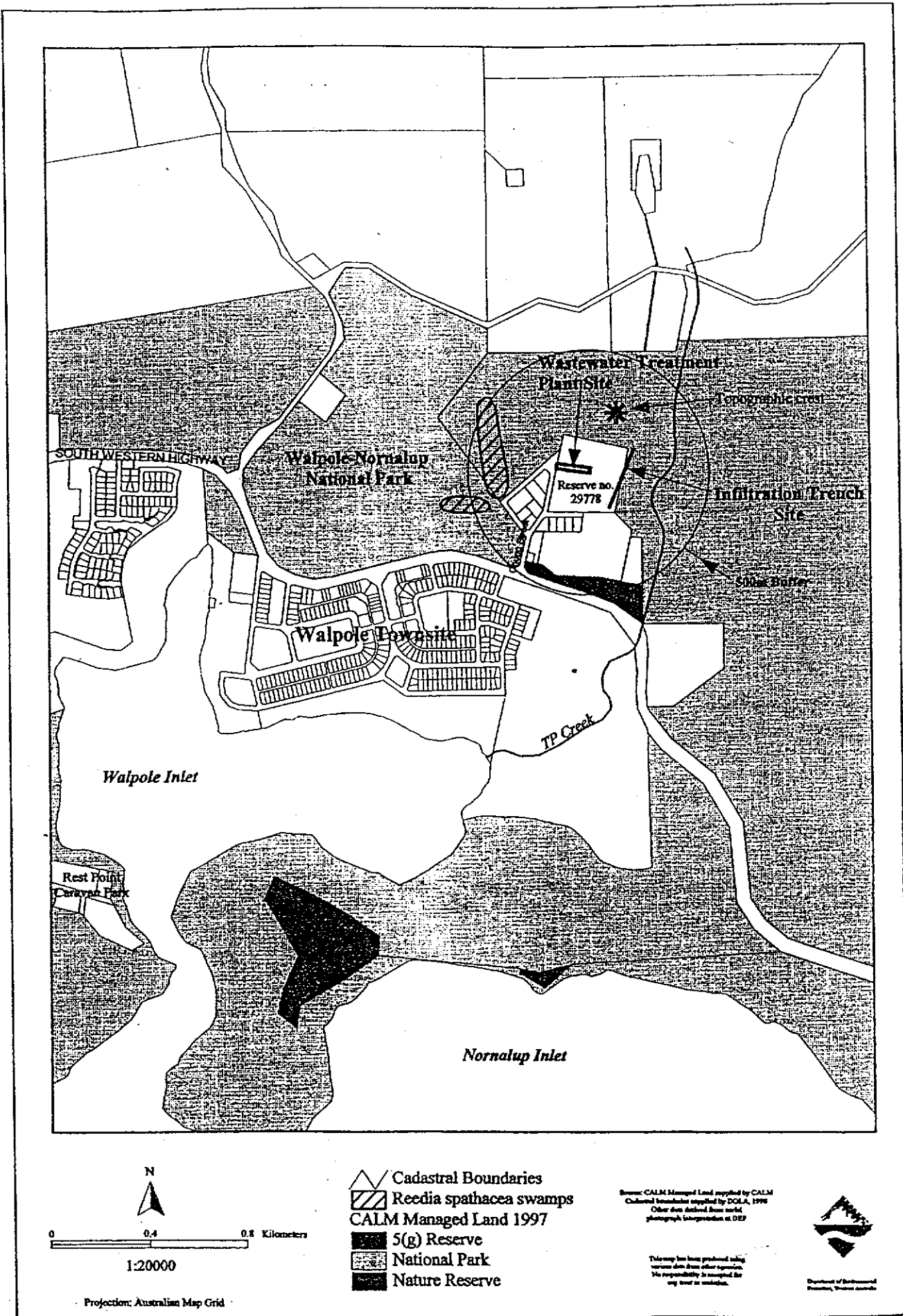
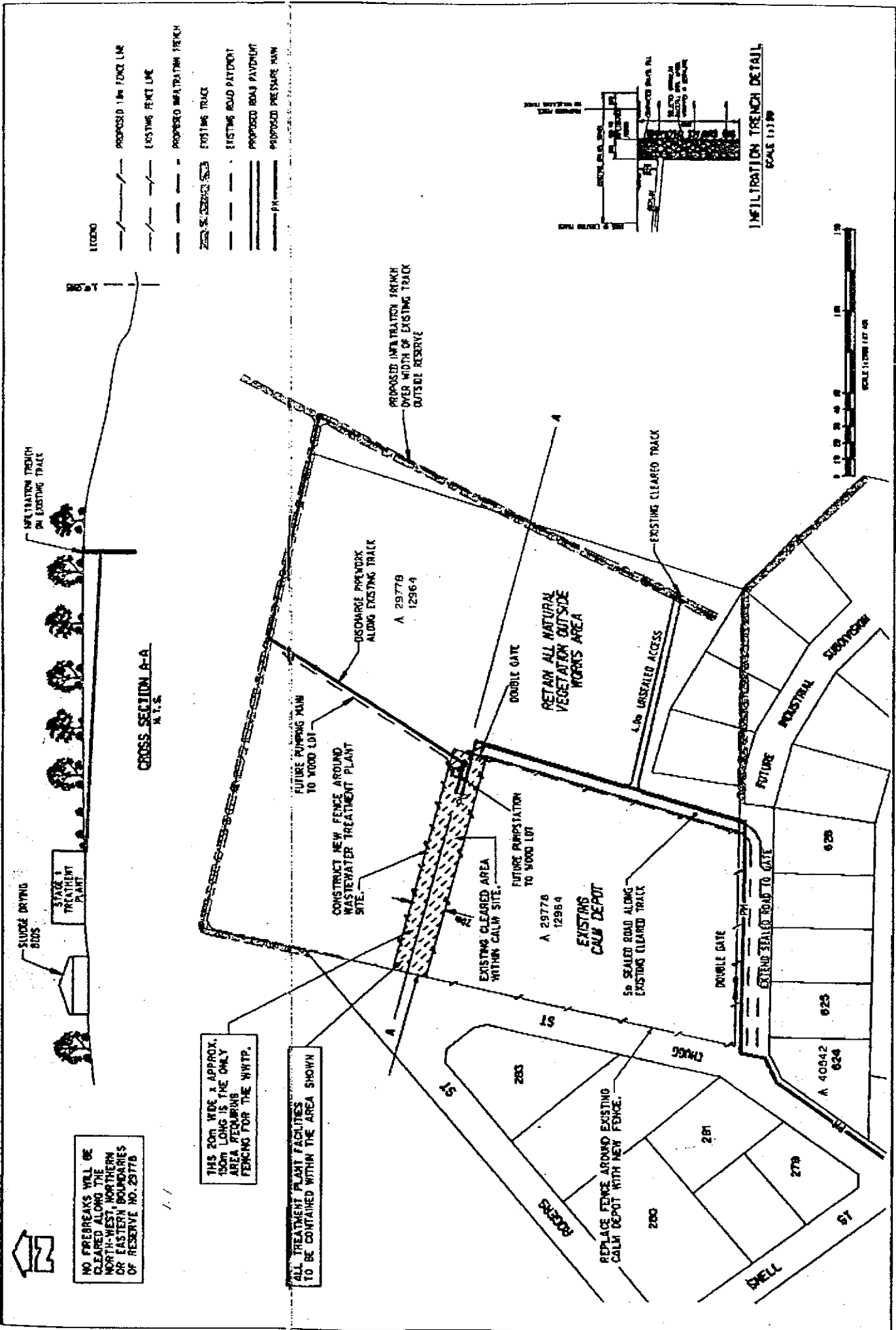

Figure 1. Location



NO FREEBREAKS WILL BE CLEARED ALONG THE NORTH-WEST, NORTHERN OR EASTERN BOUNDARIES OF RESERVE NO. 2977B

THIS 20m WIDE & APPROX. 150m LONG IS THE ONLY AREA REQUIRING FENCING FOR THE WWTP.

ALL TREATMENT PLANT FACILITIES TO BE CONTAINED WITHIN THE AREA SHOWN

- 1:0000
- PROPOSED 1.5m FENCE LINE
- EXISTING FENCE LINE
- PROPOSED INFILTRATION TRENCH
- EXISTING TRACK
- EXISTING ROAD PAVEMENT
- PROPOSED ROAD PAVEMENT
- PROPOSED PRESSURE MAIN

CROSS SECTION A-A
N.T.S.

INFILTRATION TRENCH DETAIL
SCALE 1:1000

FIGURE 2: SITE PLAN AND LAYOUT

**Proponent's Consolidated Environmental Management
Commitments**

January 1999

**WASTEWATER TREATMENT PLANT, STAGE 1
AT CHUGG STREET, WALPOLE
SHIRE OF MANJIMUP
(1154)**

WATER CORPORATION

WASTEWATER TREATMENT PLANT, STAGE 1, AT CHUGG STREET, WALPOLE, SHIRE OF MANJIMUP (1154)

Commitment	Objective	Action	Timing	Whose advice	Measurement/Compliance criteria
1. Minimise changes to existing shallow groundwater flow and groundwater recharge within the treatment plant site.	Maintain offsite sedgeland vegetation.	Issue tender documents for the design and construction which incorporate specifications requiring that all rainfall from hard surfaces is redirected to the ground.	Before design phase.	DEP, WRC.	Tender documents submitted to DEP.
2. Maintain optimum process efficiency for nutrient removal and final effluent disposal by a subsoil infiltration trench (until a treelot is commissioned).	Maintain estuary water quality, groundwater quality and surface water quality.	Design, construct and operate WWTP to achieve 10 mg/L N, 1 mg/L P.	Design and operational phase.	DEP, WRC.	Annual monitoring report to DEP.
3. Monitor and report on surface water and groundwater quality (including chemistry and water levels) on the western margin of TP Creek and within TP Creek. Install additional monitoring bore in mid-section of proposed infiltration trench.	Maintain estuary water quality, groundwater quality and surface water quality.	Monitor, and report to DEP. Install additional monitoring bore.	Monitor and report during operational phase. Install monitoring bore and commence monitoring from that bore, prior to commissioning of infiltration trench.	DEP, WRC	Annual performance compliance report to DEP. Report on additional monitoring bore to DEP prior to commissioning of infiltration trench.
4. Control odour.	Maintain the amenity of nearby residents.	Operate the WWTP to eliminate production of odour so that there are no detectable odours outside a 500 metre radius from the plant, and in the event of nuisance odour, implement odour control.	Operational phase.	DEP.	Annual monitoring report to DEP.

Commitment	Objective	Action	Timing	Whose advice	Measurement/Compliance criteria
5. Implement dieback control program.	Maintain vegetation health.	Develop hygiene protocols and implement them.	Construction phase.	CALM, DEP.	Letter from CALM.
6. Prevent introduction of weeds.	Prevent degradation of vegetation by the introduction of weeds.	In the event of a screening buffer being planted, develop and implement land use management program. Locally sourced native species will be used for any revegetation or rehabilitation work.	Operational phase.	CALM, DEP	Development of plan: letter from CALM. Implementation: performance compliance report submitted to DEP.
7. Within 12 months of the issuing of formal authority from the Minister for the Environment, the proponent will identify and reach agreement on the establishment of a suitably sized treelot to ensure that it is available to meet commitment No. 8.	Maintain groundwater quality, surface water quality and vegetation health.	Identify and reach agreement on the establishment of a suitably sized treelot	Within 12 months of the issuing of formal authority from the Minister for the Environment.	DEP, WRC.	Performance compliance report submitted to DEP.

Commitment	Objective	Action	Timing	Whose advice	Measurement/Compliance criteria
8. Cease normal disposal to infiltration trench and commence disposing to treelot when disposal volumes exceed 60 m ³ /day, or within 5 years, whichever is sooner. Commence disposal to treelot if it is demonstrated that discharge to infiltration trench is causing degradation to groundwater quality, surface water quality or vegetation health.	Maintain groundwater quality, surface water quality and vegetation health.	Cease disposing to infiltration trench and commence disposing to treelot when disposal volumes exceed 60 m ³ /day. Commence disposal to treelot if it is demonstrated that discharge to infiltration trench is causing degradation to groundwater quality, surface water quality or vegetation health.	Disposal volumes exceed 60 m ³ /day, or within 5 years of the issuing of formal authority from the Minister for the Environment, or if it is demonstrated that discharge to infiltration trench is causing degradation (whichever occurs first).	DEP, WRC.	Performance compliance report submitted to DEP.
9. Manage incidents (including overflows, shutdowns, power failures and the like).	Maintain estuary, groundwater quality, surface water quality and vegetation health and prevent odours.	Develop site specific incident management plans.	Prior to commissioning.	DEP.	An approved incident management plan.
10. Dried sludge will be disposed of to an approved site.	Maintain estuary, groundwater quality, surface water quality and vegetation health.	Dispose of dried sludge to an approved site.	For the life of the plant.	Shire of Manjimup.	Letter from the Shire of Manjimup.
11. Prevent degradation of vegetation within the Walpole-Nornalup National Park.	Maintain health of vegetation within the Walpole-Nornalup National Park.	If it is demonstrated that the WWTP has caused damage to the vegetation within the Walpole-Nornalup National Park, negotiate appropriate mitigation (most likely in the form of a land swap) with NPNCA.	For the life of the plant.	NPNCA.	Letter from the NPNCA confirming that mitigation, if required, is adequate.

Commitment	Objective	Action	Timing	Whose advice	Measurement/Compliance criteria
12. Prevent deterioration of vegetation downslope from the infiltration trench.	Maintaining vegetation health.	Undertake a vegetation survey (including identification of Declared Rare Flora) prior to construction to establish a baseline, and develop and implement a long-term monitoring program.	Within 1 month of the issuing of formal authority from the Minister for the Environment, submit the vegetation survey report.	DEP, CALM.	Submission of the vegetation survey and monitoring program to DEP. Implementation: submission of performance compliance report to DEP.
13. Implement systems and procedures to ensure that commitments are met.	Address estuary, groundwater quality, surface water quality and vegetation health.	Develop and implement an Environmental Management System.	Construction phase, operational phase and decommissioning phase.	DEP.	Submission of EMS to DEP.
14. Develop and implement a decommissioning management plan for the WWTP and associated infrastructure, including the sub-surface infiltration trench.	Maintain estuary, groundwater quality, surface water quality and vegetation health.	Develop decommissioning management plan addressing removal of plant and infrastructure, rehabilitation of disturbed areas and identification of contaminated areas. The plan will be made publicly available.	At least 6 months prior to decommissioning the WWTP.	DEP, CALM, WRC.	Development: submission of a decommissioning management plan. Implementation: Submission of a performance compliance report.
15. Design and operate infiltration trench so that individual sections can be de-activated.	Maintain estuary water quality, groundwater quality and surface water quality.	Design and operate infiltration trench so that individual sections can be de-activated if it is demonstrated by monitoring data that groundwater table is being intersected by the trench.	Design and operational phase	DEP	Designs submitted to DEP, annual performance compliance report to DEP.

Abbreviations:

CALM Department of Conservation and Land Management
 DEP Department of Environmental Protection
 EMS Environmental Management System
 EPA Environmental Protection Authority
 NPNCA National Parks and Nature Conservation Authority
 WWTP Wastewater Treatment Plant